

N=No Metallization
0=No Connection R0169B

LEAD FRAME			DIE CAVITY A x B	OVERALL C x D	LAYER THICKNESS					KYOCERA CERAMIC MATERIAL CODE A440: Black A473: White	CONNECTION		DRAWING NUMBER
LEAD FORMING	LEAD COUNT	LEAD PITCH			1ST	2ND	3RD	4TH	TOTAL		SEAL RING	DIE ATTACH	
GULL WING	16	1.27	7.20 X 4.33	10.45 X 7.45	0.30	0.38	0.72	0.55	1.95	A440	0	0	PB-F86651-B
GULL WING	16	1.27	7.20 X 4.33	10.45 X 7.45	0.381	0.635	0.384	0.55	1.95	A440	0	0	PB-F88151
GULL WING	20	1.27	7.20 X 4.10	12.80 X 7.45	0.30	0.46	0.64	0.55	1.95	A440	0	0	PB-F86652-C
GULL WING	20	1.27	7.20 X 4.33	12.80 X 7.45	0.381	0.635	0.384	0.55	1.95	A440	0	0	PB-F88152
GULL WING	24	1.27	7.20 X 4.33	15.40 X 7.45	0.38	0.38	0.64	0.55	1.95	A440	0	0	PB-F86653-A
GULL WING	28	1.27	7.20 X 4.33	17.90 X 7.45	0.38	0.38	0.64	0.55	1.95	A440	0	0	PB-F86065-A
GULL WING	28	1.27	7.20 X 4.33	17.90 X 7.45	0.381	0.635	0.384	0.55	1.95	A440	0	0	PB-F88154
J FORMED	28	1.27	15.75 X 8.38	18.29 X 11.05	0.635	0.508	0.762	-	1.905	A440	0	A, B	PB-F90387-B
J FORMED	32	1.27	16.51 X 6.86	20.88 X 10.80	0.508	0.635	0.889	-	2.032	A440	N	N	PB-F90335
FLAT	10	1.27	3.30SQ	6.48SQ	0.457	0.457	0.381	0.508	1.803	A473	N	0	KD-83515
FLAT	10	1.27	3.30SQ	6.48SQ	0.508	0.457	0.356	0.330	1.855max.	A473	0	0	KD-F85511
FLAT	14	1.27	3.05 X 2.67	6.48 X 5.08	0.381	0.381	0.381	0.254	1.397	A440	0	14	KD-F89036
FLAT	14	1.27	3.81SQ	6.48SQ	0.457	0.457	0.279	0.508	1.702	A440	0	0	KD-F88131
FLAT	14	1.27	6.48min. X 3.96min.	9.91max. X 6.48	0.635	0.635	0.203	0.889	2.362	A440	0	0	KD-F89980-D
FLAT	14	1.27	7.37 X 6.35	9.91SQ	0.762	0.508	0.381	0.381	2.032	A473	0	0	KD-F89159-B

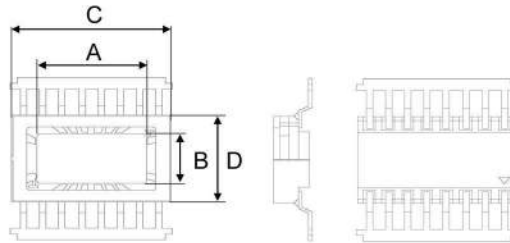

N=No Metallization
0=No Connection R0169B

LEAD FRAME			DIE CAVITY A x B	OVERALL C x D	LAYER THICKNESS					KYOCERA CERAMIC MATERIAL CODE A440: Black A473: White	CONNECTION		DRAWING NUMBER
LEAD FORMING	LEAD COUNT	LEAD PITCH			1ST	2ND	3RD	4TH	TOTAL		SEAL RING	DIE ATTACH	
FLAT	16	1.27	4.19 X 3.81	9.94 X 6.91	0.381	0.635	0.381	0.381	1.778	A473	0	0	KD-F86435-A
FLAT	16	1.27	6.10 X 4.42	10.03 X 7.29	0.483	0.483	0.254	0.483	1.702	A473	0	0	KD-85198-B
FLAT	16	1.27	7.37 X 4.34	10.16 X 7.11	0.483	0.483	0.254	0.483	1.702	A473	0	0	KD-83454
FLAT	16	1.27	7.62 X 6.86	10.16SQ	0.508	0.508	0.254	0.381	1.651	A440	0	0	KD-83714-A
FLAT	18	1.27	6.60 X 4.57	11.18 X 8.38	0.508	0.508	0.254	0.762	2.032	A440	9	18	KD-F86A96
FLAT	18	1.27	6.60 X 4.57min.	11.18max. X 7.87	0.483	0.635	0.254	0.483	1.855	A440	0	0	KD-83099-A
FLAT	20	1.27	5.59min. X 3.56min.	10.11 X 6.86	0.432	0.406min.	0.203	0.508	1.600	A440	0	0	KD-82224-B
FLAT	20	1.27	8.13 X 4.32	12.20 X 8.85	0.381	0.635	0.254	0.508	1.778	A440	0	0	KD-85034
FLAT	20	1.27	12.20 X 6.60	15.50 X 9.27	0.381	0.508	0.381	0.889	2.159	A440	0	0	KD-F87527-C
FLAT	24	1.27	6.86 X 5.59	15.24 X 10.16	0.508	0.508	0.254	0.508	1.778	A473	0	0	KD-F83389
FLAT	24	1.27	8.89 X 6.10	15.24 X 10.16	0.508	0.508	0.254	0.889	2.159	A473	0	0	KD-F89139-A
FLAT	24	1.27	8.89 X 7.62	15.24 X 10.16	0.635	0.635	0.254	0.508	2.032	A440	0	0	KD-F86043-C
FLAT	28	1.27	6.35 X 5.08	18.29 X 12.70	0.508	0.635	0.305	0.889	2.337	A440	0	0	KD-F89140-A
FLAT	28	1.27	8.89 X 7.37	18.29 X 12.70	0.381	0.762	0.305	0.381	1.829	A440	0	0	KD-F86498
FLAT	42	1.27	7.62SQ	26.92 X 16.26	0.635	0.635	0.762	-	2.032	A473	0	0	KD-F89735-A
FLAT	42	1.27	7.87SQ	26.92 X 16.26	0.635	0.635	0.762	-	2.032	A473	0	0	KD-F87371